

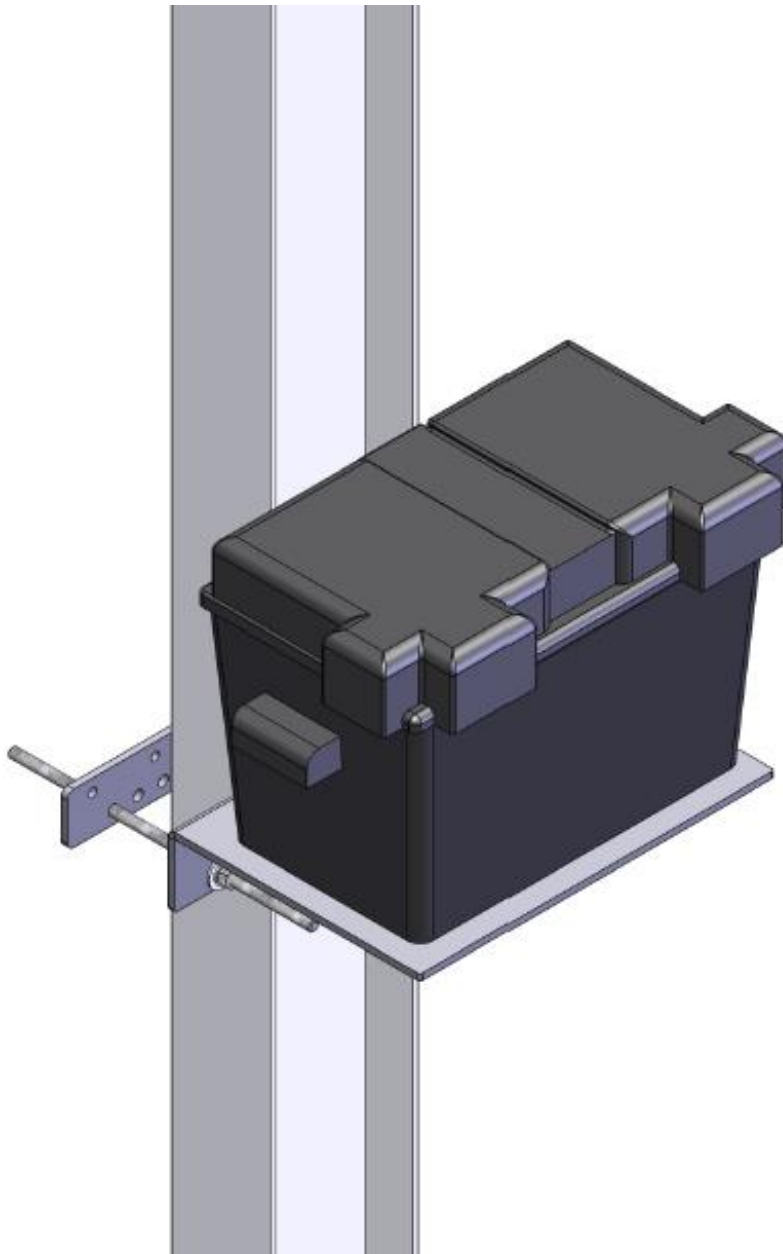

## Introduction

These instructions explain how to use the Pile Mount Battery Bracket. This bracket is compatible with square piles up to 10" wide. The battery platform is made from a single sheet of 1/4" aluminum, CNC-cut & bent into form and can accept one battery secured using ratchet straps (not included).

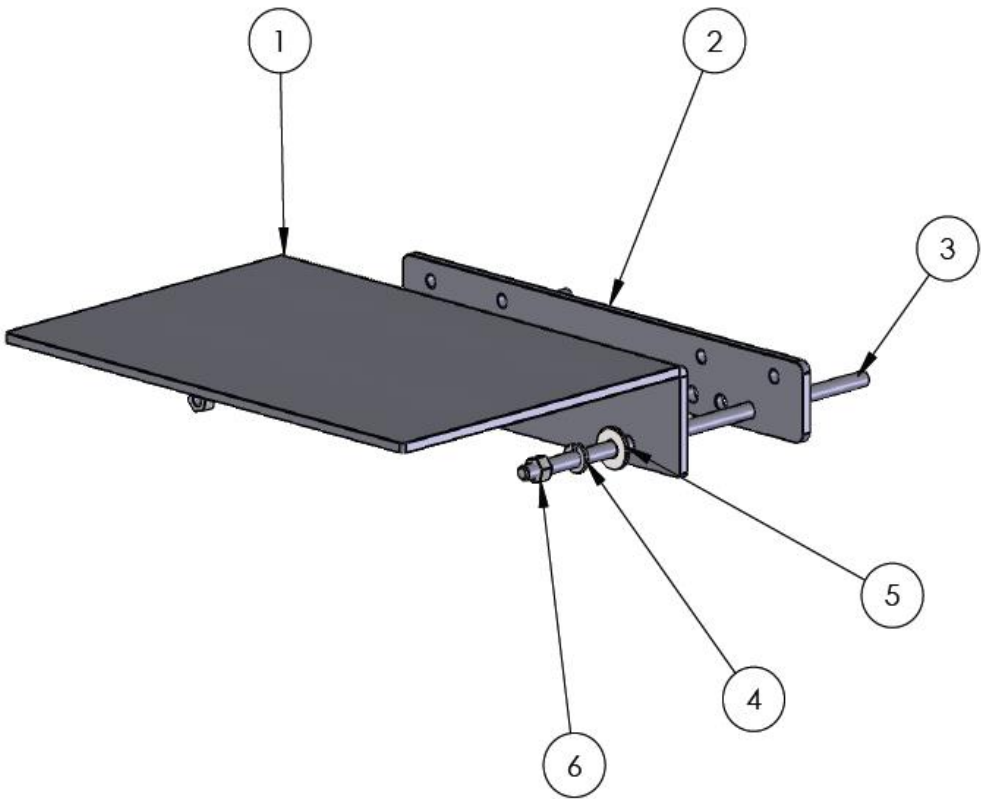



#17797: Parts/BOM

NRG Part Number	Part Description	Part Specification	Quantity	Diagram Key
17796	Battery Bracket	Battery Bracket, Pile Mounted x 1	1	1
15061	Universal Bracket	Bracket, Shelter Box 18x16, Universal	1	2
15071	Threaded Rod	Rod, Threaded, 0.375-16, 12in, Galv	2	3
15042	Lock Washer	Washer, Lock, .375in, Galv	4	4
2814	Washer	Washer- 3/8", Flat, 7/16"ID, 1"OD, 5/64"T, USS Hot Dip Galv	4	5
1572	Nut	Nut-3/8"-16, Hex, Grade 2, Galvanized, 9/16" Wrench	4	6

Tools

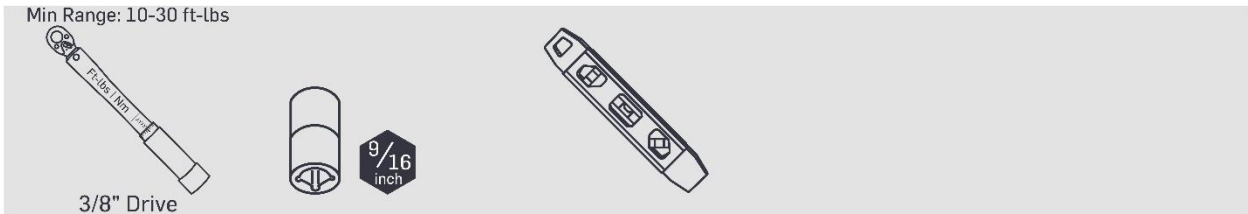



### Assembly & Mounting

- 1 The battery bracket will need to be mounted near the power supply/LOGR-S shelter box. Make sure the battery will be clear of any obstructions and high enough on the pile to avoid being affected by potential flooding.

Place a washer followed by a lock washer and nut on each threaded rod #15071. Insert the threaded rods into the battery bracket #17796 as shown below.

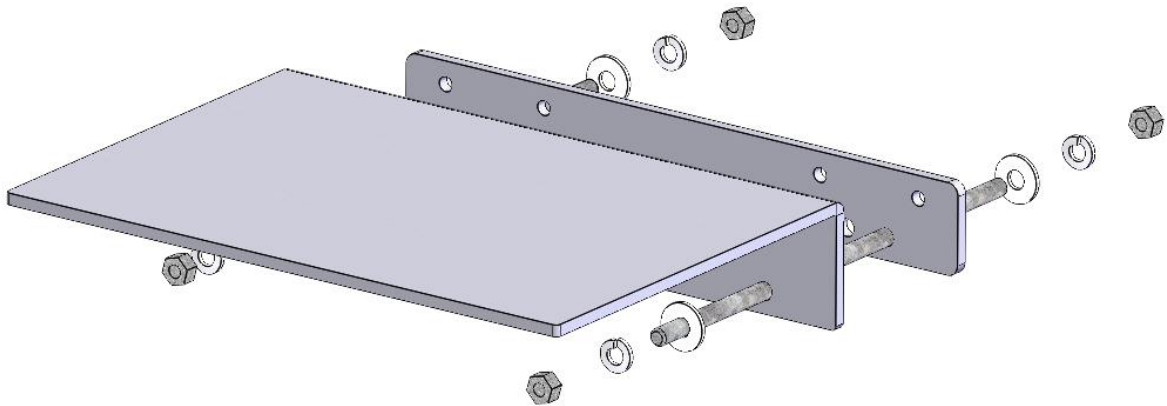



## Solar | Pile Mount Battery Bracket #17797

- Place the battery bracket at the intended location on the tower and slide the universal bracket #15061 onto the threaded rods. Secure the universal bracket with a washer, lock washer, and nut on each threaded rod as shown below.
- 2

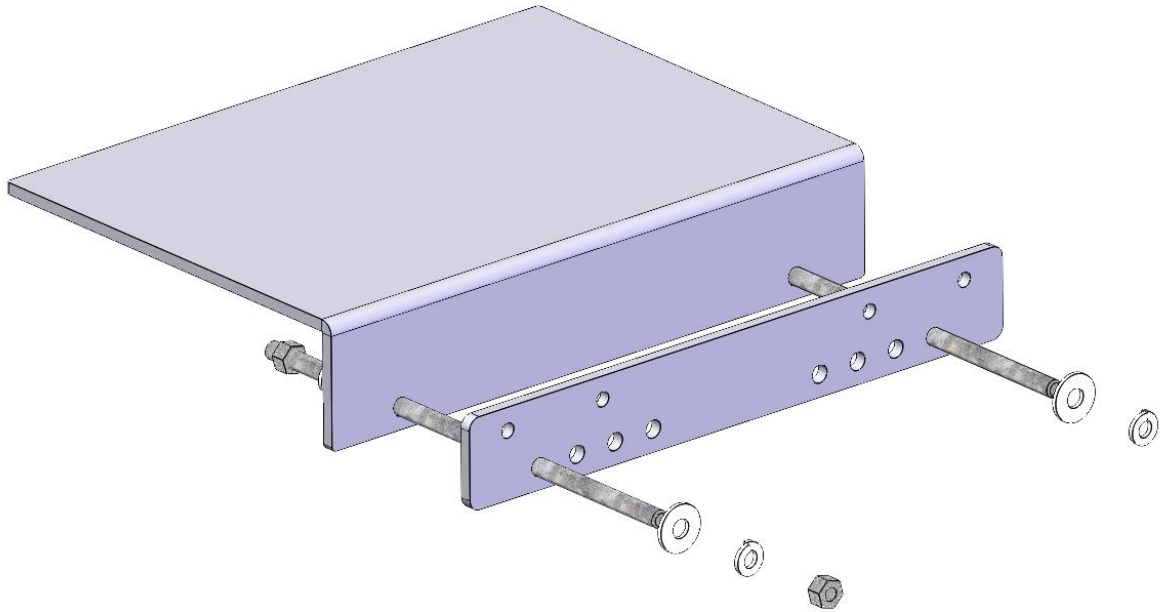

Tighten using a 9/16" nut driver. Level the plate, then torque U-bolt nuts to spec.

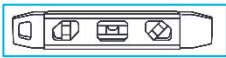

Torque specification: **25 ft-lbs (33.9 Nm)**

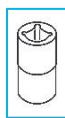

*Best practice is to mount the bracket as close to the base as possible, while also remaining above the 100-year flood level (if applicable) and in an orientation that keeps the batteries out of direct sunlight.*